

**Serie | 6, heat pump tumble dryer, 8 kg
WTR85T00AU**



Optional accessories

WMZ20600 : Wool in basket - accessory
WTZ27400 : Stacking kit with pull-out shelf
WTZ27410 : Stacking kit

Excellent energy efficiency and Drying performance

- **AutoDry:** automatically dries to the exact degree of dryness you'd like.
- **SensitiveDrying System:** for gentle drying without wrinkles.
- **AntiVibration Design:** extremely stable and especially quiet
- ActiveAir Technology reuses existing heat efficiently during the entire drying process.
- **Large LED Display:** easy operation and extra functions available.

Technical Data

Built-in / Free-standing : Freestanding
Removable top : No
Door hinge : Right
Length electrical supply cord : 145.0 cm
Height of removable worktop : 0 mm
Dimensions of the product : 842 x 598 x 613 mm
Net weight : 48.8 kg
Fluorinated greenhouse gases : No
Type of refrigerant : R290
Hermetically sealed equipment : Yes
Quantity of fluorinated gases : 0.120 kg
The quantity expressed in CO2 equivalent : 0.000 t
EAN code : 4242005206988
Connection Rating : 600 W
Fuse protection : 10 A
Voltage : 220-240 V
Frequency : 50 Hz
Approval certificates : CE, VDE
Capacity cotton - NEW (2010/30/EC) : 8.0 kg
Energy efficiency rating : A++



Serie | 6, heat pump tumble dryer, 8 kg WTR85T00AU

Excellent energy efficiency and Drying performance

Capacity

- Capacity: 8 kg

Consumption rates

- 8 Star energy rating
- 135 kWh energy consumption per year, based on the Cottons program with drying options Cupboard Extra Dry and Drying Level 1, used once per week

Programs

- Special drying programs:
 - Cottons: hard-wearing items made from cotton or linen with three desired dryless level options: Cupboard Dry / Cupboard Dry Plus / Iron Dry
 - Easy Care: items made from synthetic or blended fabrics with three desired dryless level options: Cupboard Dry / Cupboard Dry Plus / Iron Dry
 - Shirts/Blouses: designed to allow immediate ironing or hanging up shirts/blouses after the program completes
 - Delicates: items made from satin, synthetic or blended fabrics
 - Towels: hard wearing towels and dressing gowns made of cotton
 - Mixed: items made from cotton or blended fabrics
 - Super 40': short program for synthetic fabrics and light cottons
 - Sportswear: sports and leisure items made from synthetic fibres, microfibre or fleece
 - Wool: Machine washable items made of wool
 - Timed Program Cold: manually set a custom time for loosening up or airing clothing that has hardly been worn
 - Timed Program Warm: manually set a custom time for drying slightly damp or multi layered thick items
- Touch Control buttons:
 - Easy Iron: the drum moves the laundry at regular intervals after drying to prevent creasing
 - Drying Level: if you feel that the laundry is too damp when the drying program has ended you can adjust the drying level for future uses of the program to make the program run longer
 - Low Heat: reduce the drying temperature for delicate fabrics
 - Finished in (delayed start): you can delay the start of the program by up to 24 hours
 - End Signal: activate or deactivate the audible signal at the end of the program
 - Drying Time: extend the drying time on selected drying programs

Performance

- ActiveAir heat pump technology, existing heat is reused efficiently during the entire drying process
- Easy clean filter for easy maintenance
- Sensitive Drying system combines warm air and a gentle drum structure to dry clothes effectively

Design

- Anti-Vibration Side Panels reduce vibrations and ensure greater stability during the washing and spinning process.
- LED display for remaining time, 24hr time delay, program status indication, and special drying functions
- Large water condensation container: If there is no drain hose connected to the appliance the condensation water from the drying cycle will be stored in the condensation container
- Glass door with 175 ° opening angle

Convenience

- Sensor drying, monitors the temperature and moisture content to ensure garments are dried to the desired setting
- Time delay to select end of time of your wash (1-24 hours) and time remaining indicator

Safety

- Child safety control lock

Technical Information

- Dimensions (H x W x D): 84.2 cm x 59.8 cm x 61.3 cm (66.5 cm including door handle)
- Operating noise level: 64 dB(A)

Serie | 6, heat pump tumble dryer, 8 kg WTR85T00AU

Measurements in mm

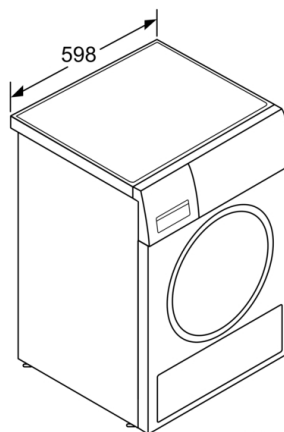
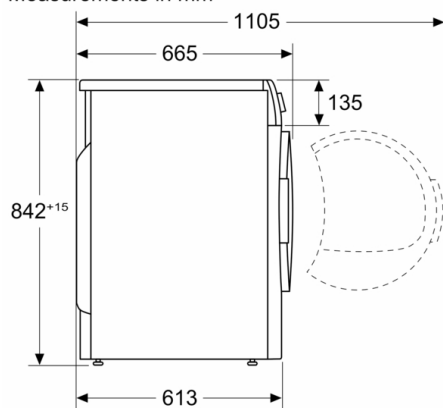

measurements in mm